

#19789 Filed This 20 day of Feb. 1969

And Recorded in Vol. 4A Page 77 at 3:21 P.

*Ollie Samworth*

Register Mesne Conveyance Greenville County, S. C.

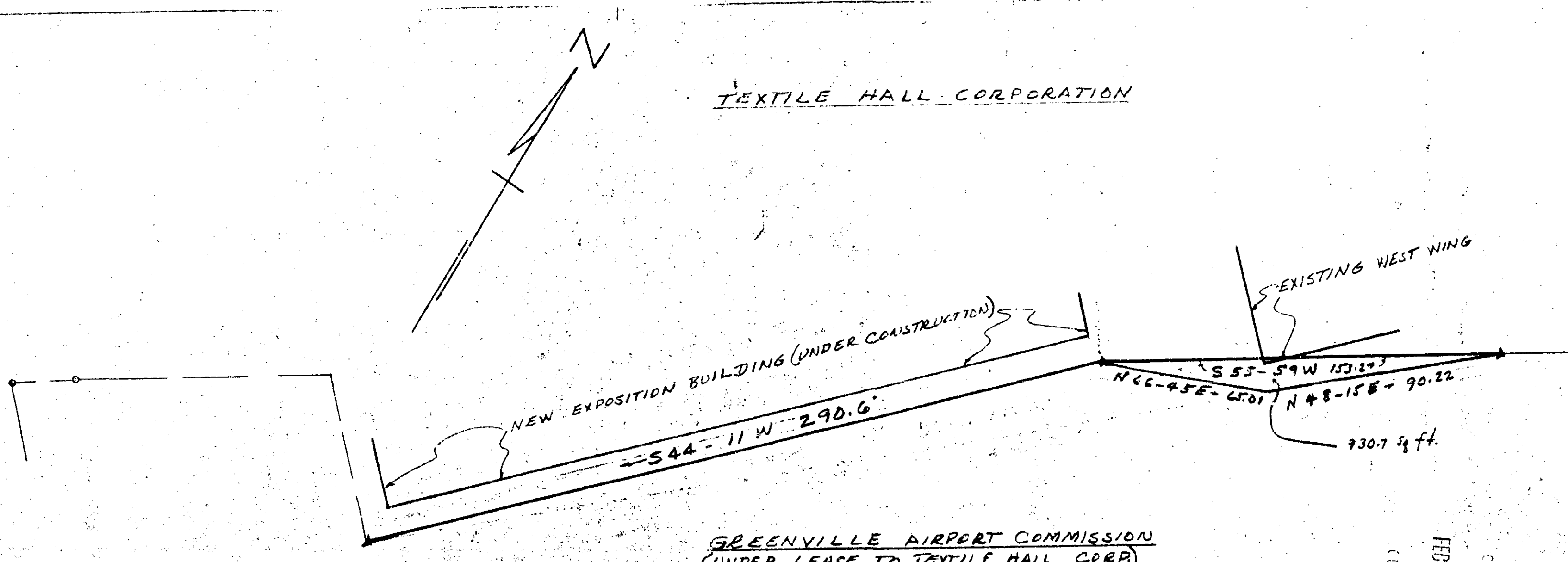

GREENVILLE AIRPORT COMMISSION  
(UNDER LEASE TO TEXTILE HALL CORP.)

PROPERTY OF  
TEXTILE HALL CORPORATION  
GREENVILLE, S.C.

FEB. 7, 1969 SCALE 1"=40

SURVEY & COMPUTATIONS BY:  
CAMPBELL & CLARKSON  
SURVEYORS, INC.  
*A. C. Clarkson* R.S.

19789

LA 77

FILED  
FEB 20 3 21 PM 1969  
GREENVILLE CO. S. C.  
Ollie Samworth

